



Data Sheet
SD-25 Series

Distributed by



www.BristolInstruments.com

Bristol Instruments
90 Canal Street
4th Floor
Boston, MA 02114

Toll free 877-866-8500

Pressure sensors with internal diaphragm and ceramic element

Accuracy 0.5 % and 1 % according to IEC 61298-2

Standard output : 4...20 mA; 2-wire system
 or 0...5 VDC; 3-wire system
 or 0...10 VDC; 3-wire system



Special features

High long-term stability and temperature compensated
 High peak pressure limits
 For dynamic and static measurements

Applications

For all gaseous and liquid pressure media, which do not attack the measuring system and do not crystallize or react viscous.

Areas of use

Mechanical engineering
 Hydraulics
 Pneumatics

Model	SD-25	SD-26	SD-27	SD-28
Accuracy	1.0 % of full scale value		0.5 % of full scale value	
Connection thread	1/2" NPT	1/4" NPT	1/2" NPT	1/4" NPT
Ranges in psi	0...25, 35, 50, 100, 150, 200, 350, 600, 1,000, 1,500, 2,000, 3,500, 5,000, 6,000 -15 to +10, -15 to +15, -15 to +50, -15 to +75, -15 to +130 -15 to +200, -15 to 300			
Overload limit	up to 3,500 psi - 2x, 5,000 and 6,000 psi - 1.5x			
Sensor element	Ceramic in monolithical construction			
Repeatability	< 0.05 % full scale value			
Stability per year	< 0.2 % full scale value in rated conditions			
Case	Stainless steel 316			
Wetted parts	Stainless steel 316L, Ceramic Al ₂ O ₃ , Viton O-Ring (FKM)			
Pressure connection	Hexagon 27 mm, Stainless steel 316L			
Electrical connection	Plug according to EN 175301-803 (DIN 43 650) / ISO 4401 with junction box			
Power supply	10...36 VDC (12...36 VDC for output 0...10 V)			
Power consumption	Output 4...20 mA: signal currency, with voltage output 8 mA			
Permissible load	Current 2-wire: $R_{max} = ((U_B - U_{B_{min}}) / 0.02)$ Ohm, voltage: $R_{min} = 10$ K Ohm			
Short-circuit protection	S + to U -			
Reverse polarity protection	U + to U -			
CE-conformity	Pressure Equipment Directive - 97/23/EG EMC-Directive to EN 61 326			
Operational life	> 50 million pressure cycles			
Temperature comp'n. range	32°F to 185°F (0...85 °C)			
Temperature coefficient	0.2 % / 10 K, zero point and span			
Response time	< 1 ms (within 10% to 90% of F. S.)			
Protection type	IP 65 to EN 60529 / IEC 529			
Temperatures	Medium: -4°F to 212°F (-20°C to 100°C), Ambient: -13°F to 176°F (-25°C to 80°C)			
Weight	0.44 lbs			

Exclusively distributed in North America by:

Dimensions and Design



Model SD-25 and SD-27

Model SD-26 and SD-28

Standard version, IP 65

Plug according to EN 175301-803 (DIN 43 650) / ISO 4401 with junction box

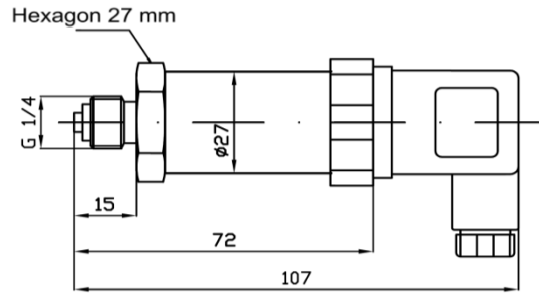
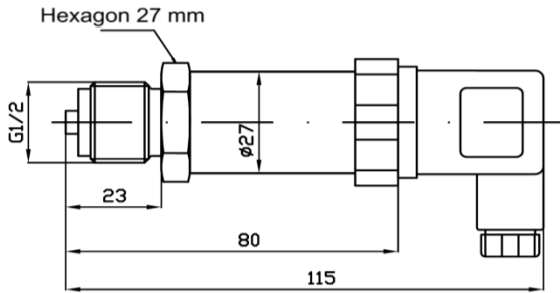

option, cooling element up to 392 °F (200 °C)

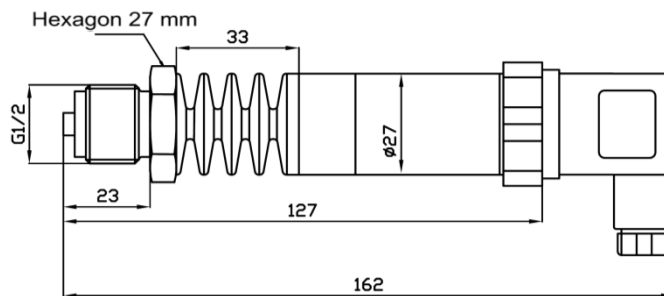

Two-wire system

4...20 mA

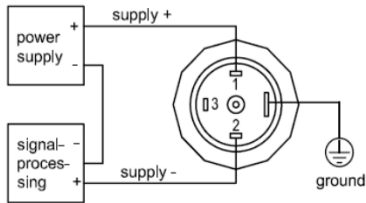

Three - wire system

0...20 mA and 0...5/10 V

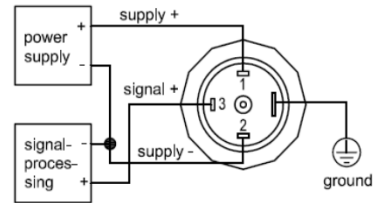

option, IP 67

Circular connector M 12 x 1. 4-pin

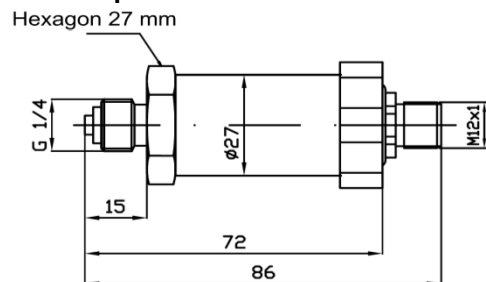
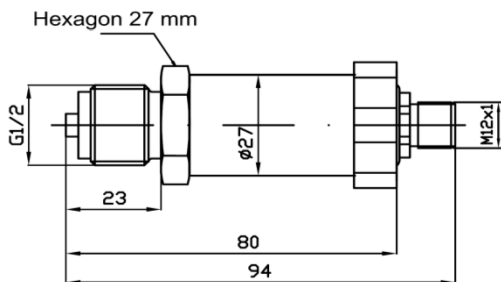

Two-wire system

4...20 mA

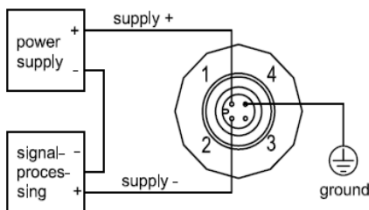

Three - wire system

0...20 mA and 0...5/10 V

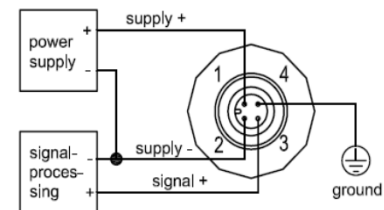

Exclusively distributed in North America by:



Phone: 877-866-8500
 www.bristolinstruments.com
 65 Sprague Street • Boston, MA 02136

Data sheet SD 250 US - 05/2017
 Page No. 2

Modifications reserved

Dimensions and Design

Model SD-25 and SD-27

Model SD-26 and SD-28

option, IP 67 or IP 68
cable outlet with 2 meters securely connected PVC-cable,

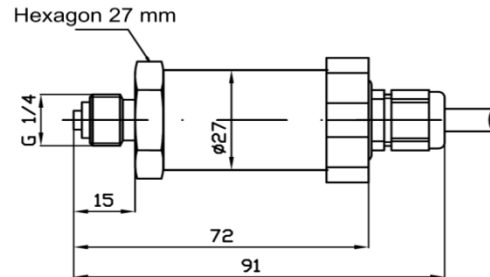
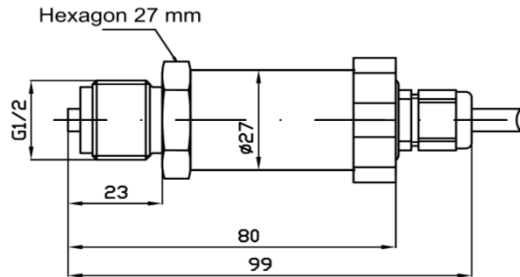

Two-wire system 4...20 mA

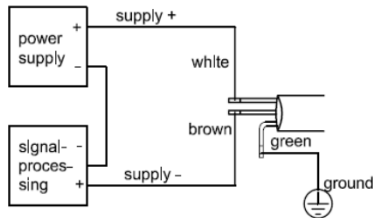

cable colours to DIN 47 100

Three - wire system 0...20 mA and 0...5/10 V

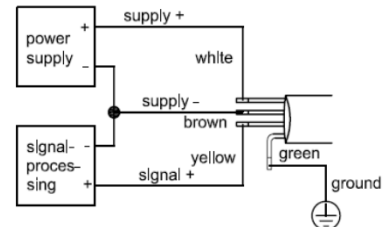

cable colours to DIN 47 100

option, IP 67 compact field housing

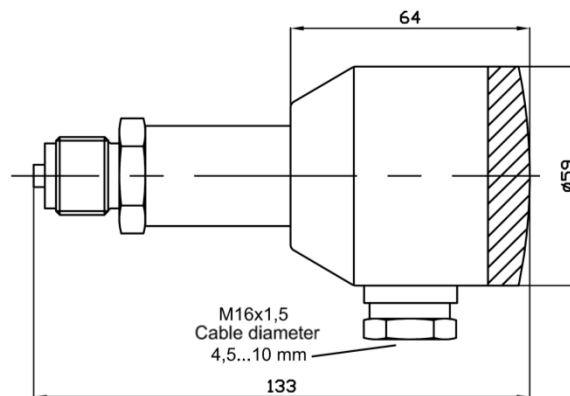

Exclusively distributed in North America by: